

JinHang Quick Connect



SPECIFICATION

SKU	JHE-SPB04-NZ	MATERIAL	Polycarbonate
RATED VOLTAGE	250V A.C.	DIMENSION	70x46x47 mm
RATED CURRENT	10A Max	IP RATING	IP20
FREQUENCY	50Hz	HOLE CUT	70mm
CONDUCTOR RANGE	1.0-2.5mm ² (DO NOT use for conductors outside this range)		
MOUNTING TYPE	Surface	FIXING CENTER	50mm
WARRANTY	3 years	STANDARD	AS/NZS 3112 AS/NZS 3100

WARNING

- This product must be installed by a licensed electrician.
- Electricity can cause serious injury or death. Disconnect power supply before connecting or disconnecting this product.

Note: Due to the nature of the contact used in this product, a standard instrument probe **SHALL NOT** be used for both installation and continuity testing. A loaded plug or instrument probes with flat pins **MUST** be used.

INSTALLATION INSTRUCTIONS

- Remove outer sheathing to required length with wire stripper. Approximately 46mm for mid connection or 70mm for end connection.

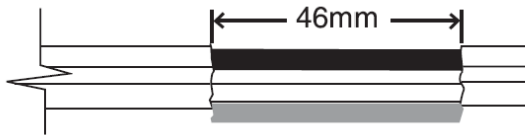
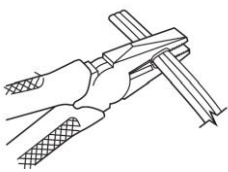

Mid connection

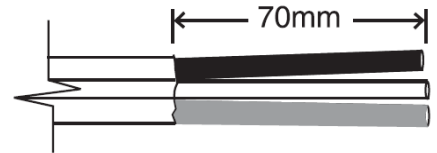

End connection

- Insert stripped cable into the terminal paths. Ensure correct polarity by matching the color coding of the cable and slots. (Neutral = Black, Earth = Green, Active = Red)

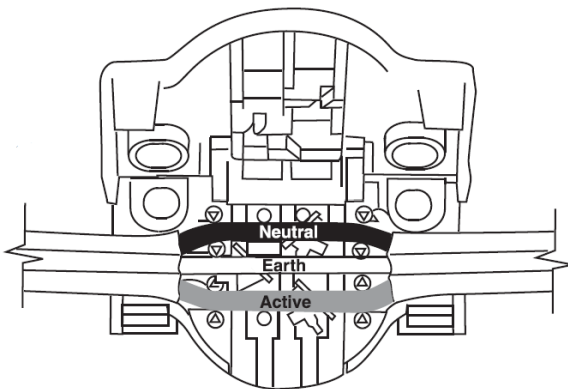

Mid connection

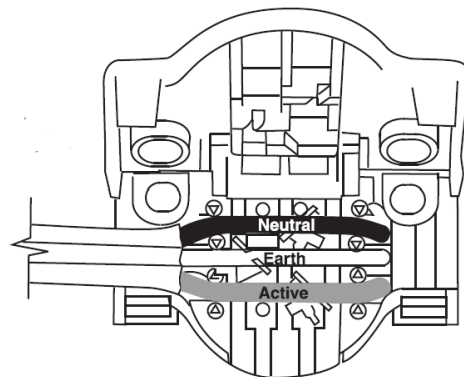

End connection

- Close cover and squeeze until both clips click. Use pliers if necessary.

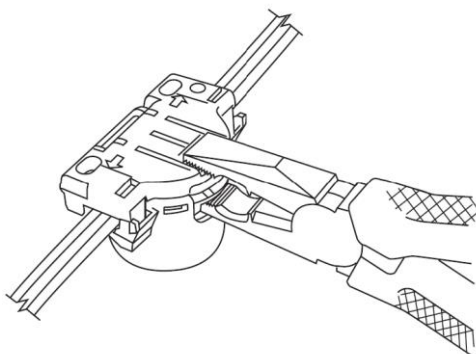

- Insert tool and twist to release clips on both ends when reopen.

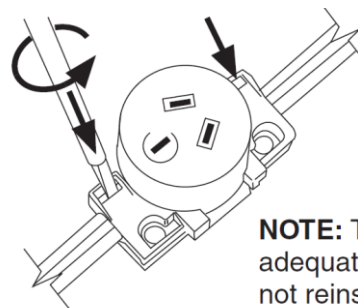

NOTE: To ensure adequate connection, do not reinstall in the same position on the cable.